

# GRAND RIVER BANK

## GRB Mobile

Securely access your personal bank accounts from your mobile device to check balances, pay bills, transfer funds (internally and externally), send money via PopMoney and deposit checks.

Download  
GRB Mobile from your App store



Log into your account

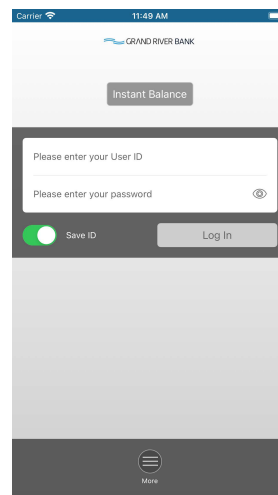

View your accounts

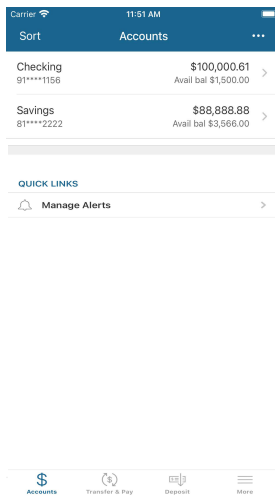

Make transfers between  
accounts

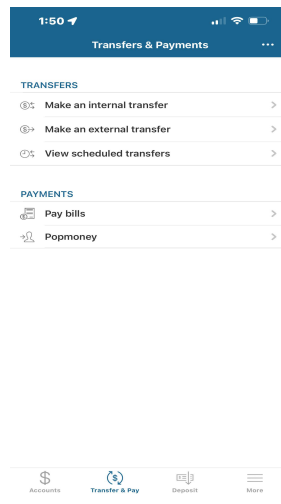

Pay Bills

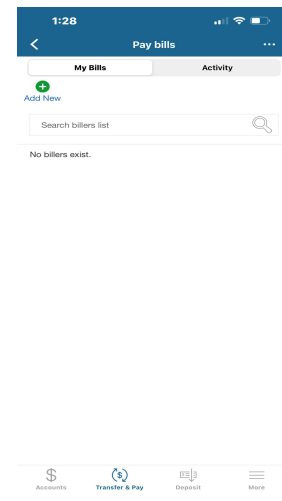

For additional assistance, please contact Customer Service at 616.929.1600

## Deposit a Check



## Send money to friends with Popmoney

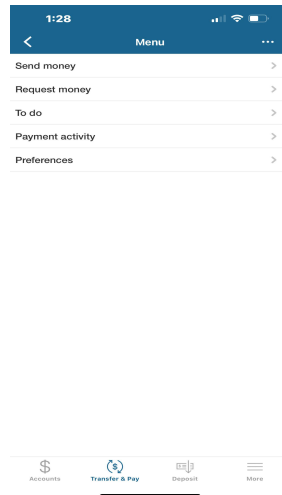

## Enable Facial Recognition with Popmoney

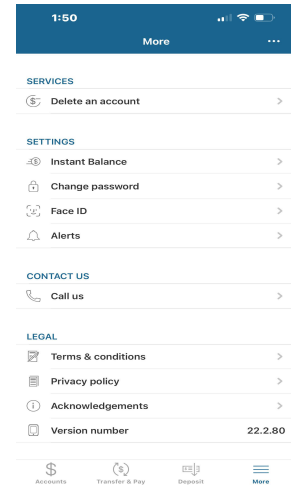

### Things to know for Mobile Deposit:

- Endorse the back of your check
- When taking photos of the check:
  - Flatten folded or crumpled checks before taking photos
  - Keep the check within the view finder on the camera when capturing photos
  - Place check on a solid dark background with good lighting before taking photo
- The maximum daily deposit limit is \$2,500
- The cut off time for same day deposits is 4:00 pm Eastern Standard Time
- The status of your deposit is available on the GRB Mobile App - Deposits tab - View history
- When the check is accepted, write "Mobile Deposit" on the front of the check to reduce risk of accidentally re-depositing
- Shred your check 7 days after the deposit is accepted